

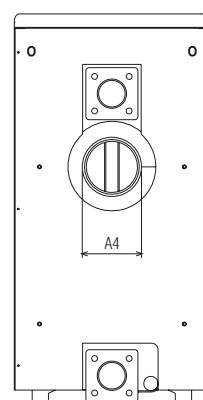

- High efficiency floor-standing heat generator fitted for jet burners on liquid and/or gas fuel, with **partial flame reversal** and one flue pass, cooled combustion chamber, for the production of hot water for central heating
- G20 cast-iron boiler body made from pre-assembled elements (6÷14) with steel cone inserts and boiler studs, insulated by a layer of rock wool lined by special tear-proof material.
- Control board includes: temperature and pressure gauge, overheat cut-off thermostat, switch on/off test, presetting led for the burner lockout, 2 stages regulation thermostat, lodging for an electronic controller
- Supplied in **three boxes**:
  - 1) boiler body in a wooden crate
  - 2) jacket packaged in a cardboard box
  - 3) instrument panel packaged in a cardboard box
- **Fitted for two-stage burners**

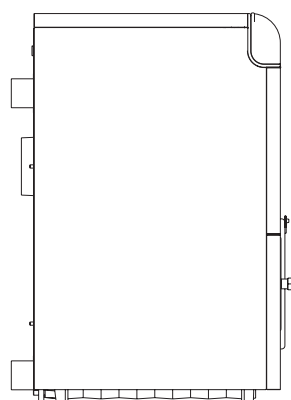

### SCHEME

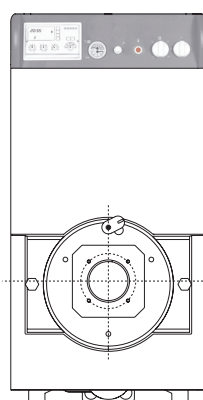

MODEL			F 107	F 126	F 144	F 162	F 180	F 198	F 216	F 234	F 252
Heat input	Max	kW	116,0	136,9	156,5	176,0	195,6	215,2	234,7	254,3	273,9
	Min	kW	95,0	110,0	125,0	140,0	155,0	170,0	185,0	200,0	215,0
Heat output	Max	kW	107,0	126,0	144,0	162,0	180,0	198,0	216,0	234,0	252,0
	Min	kW	87,0	101,0	115,0	129,0	143,0	157,0	171,0	185,0	199,0
Number of elements		no.	6	7	8	9	10	11	12	13	14
Water content		dm³	57	65	73	81	89	97	105	113	121
Combustion chamber	volume	dm³	77,0	91,0	104,0	118,0	132,0	146,0	160,0	174,0	187,0
Heating operating pressure	Max	bar	6	6	6	6	6	6	6	6	6
Pressure drop:											
		Δp mbar	0,4	0,4	0,4	0,4	0,4	0,4	0,4	0,4	0,4
combustion chamber											
hydraulic		ΔT 20°C	-	0,5	0,8	1,8	2,2	2,6	3,2	4,0	4,5
Boiler body weight		kg	361	412	463	514	565	616	670	725	780
Dimensions	A4	mm	180				200				
	WxHxD	mm	600x1196x757	600x1196x867	600x1196x977	600x1196x1087	600x1196x1197	600x1196x1307	600x1196x1417	600x1196x1527	600x1196x1637
CODE (see page 3)			017J6BXD	017J7BXD	017J8BXD	017J9BXD	017JABXD	017JBBXD	017JCBXD	017JDBXD	017JEBXD